

STENNER

Vhm36 Band Re-saw



Vhm 36 mounted on plinth for use without pit.



Removal of feed rollers for wide board cutting



True radial arm feed gear and multi-roller fence for accuracy.



Easily set tilt fence for angle cutting

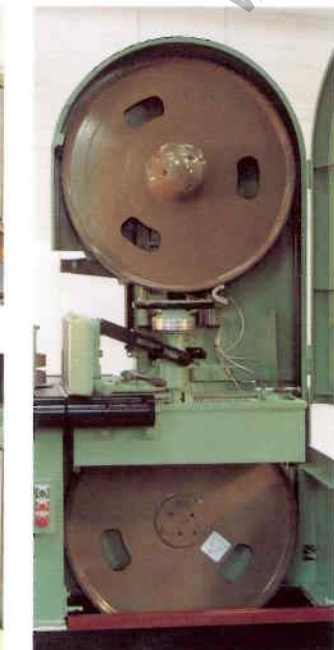

Heavy construction with quick blade change

The Vhm 36 is probably the most popular band resaw ever produced. Over 5000 have been installed in all five continents and have created a tremendous reputation for accuracy, reliability and long life.

Benefits: Features

- **Easy installation, quick resiting:** Simple foundation if pit used. No pit when plinth used.
- **Maximum safety:** Fully guarded.
- **Vibration free cutting:** Heavy steel fabrication.
- **Long life:** Engineered for quality to run for many years.
- **Uses wide bandsaw blades:** Heavy machined cast saw wheels.
- **No tyre replacement problems:** Crowned wheels.
- **Straight cutting for long periods:** Wide tensioned saw blades used.
- **Minimum waste, maximum yield:** Thin saw kerf.
- **Stable saw blade for accurate cutting:** Pressure saw guides.
- **Quick maintenance:** Replaceable saw guide pads.
- **Adequate power:** 15kW or 18kW (20HP or 25HP) motor.
- **Soft start:** Star Delta starting.
- **Maximum traction on workpiece:** True radial arm feed.
- **Correct feed speeds:** 4 fixed feeds or infinitely variable system.
- **Minimum down time:** Quick feed speed change and quick saw change with foot-operated pulley brake.
- **Positive grip and climbability:** Large diameter feed wheels.
- **Wide board cutting:** Quickly removable feed rolls.
- **Special feed rolls available:** Arris rail, rubber, spiked, toothed etc.
- **Good workpiece support and accurate dimension sawing:** Large rigid fence.
- **Smooth timber flow:** Sealed bearing multi-roll fence.
- **No traps for thin boards:** Fence base close to table.
- **Angle cutting:** Integral fence tilting device produces any angle between 0° and 45°, and is easily set and locked.
- **Large capacity:** 230mm (9") fence opening.
- **Deep sawing capability:** 406mm (16") under saw guide.
- **Easy timber entry:** Idling rollers at front of table, with foot pedal fence opening.
- **Easy timber return:** Large flat table with idling rollers.
- **No hydraulic or pneumatic failure problems:** Jack screw saw strain system.
- **Sensitive, strong and reliable saw strain:** Positive spring system.
- **Effective control of resin and sawdust build up and less noise generation:** Saw and wheel cleaning by scraper and pad.
- **Correct flow of cleansing fluid:** Controlled drip feed cleansing system.
- **No fire hazard:** Cleansing fluid automatic cut off.
- **'Maintenance needed' warning:** Low level fluid indicator light.
- **No clogging:** Sawdust extraction point when using plinth.
- **Move by truck or crane:** Lifting points.
- **Easy operator training and enhanced safety:** Simple controls with emergency stop.
- **Full parts and labour guarantee:** For 12 months.
- **Trouble free operation into the next Century:** Full spares and service support.
- **Easy to operate:** No gimmicks.
- **Reduced labour costs:** Use in tandem or in multiple in-line formats.
- **Best 'Value for Money' machine on the market:** Low capital cost.

The Vhm 36 is successfully used by production sawmills in green and dry mill applications. It is also suitable for joinery, construction, merchant and similar applications. The tilt fence makes it ideal for those users who have a wide variety of angles to produce.

All dimensions shown in mm (and inches in brackets) are approximate.

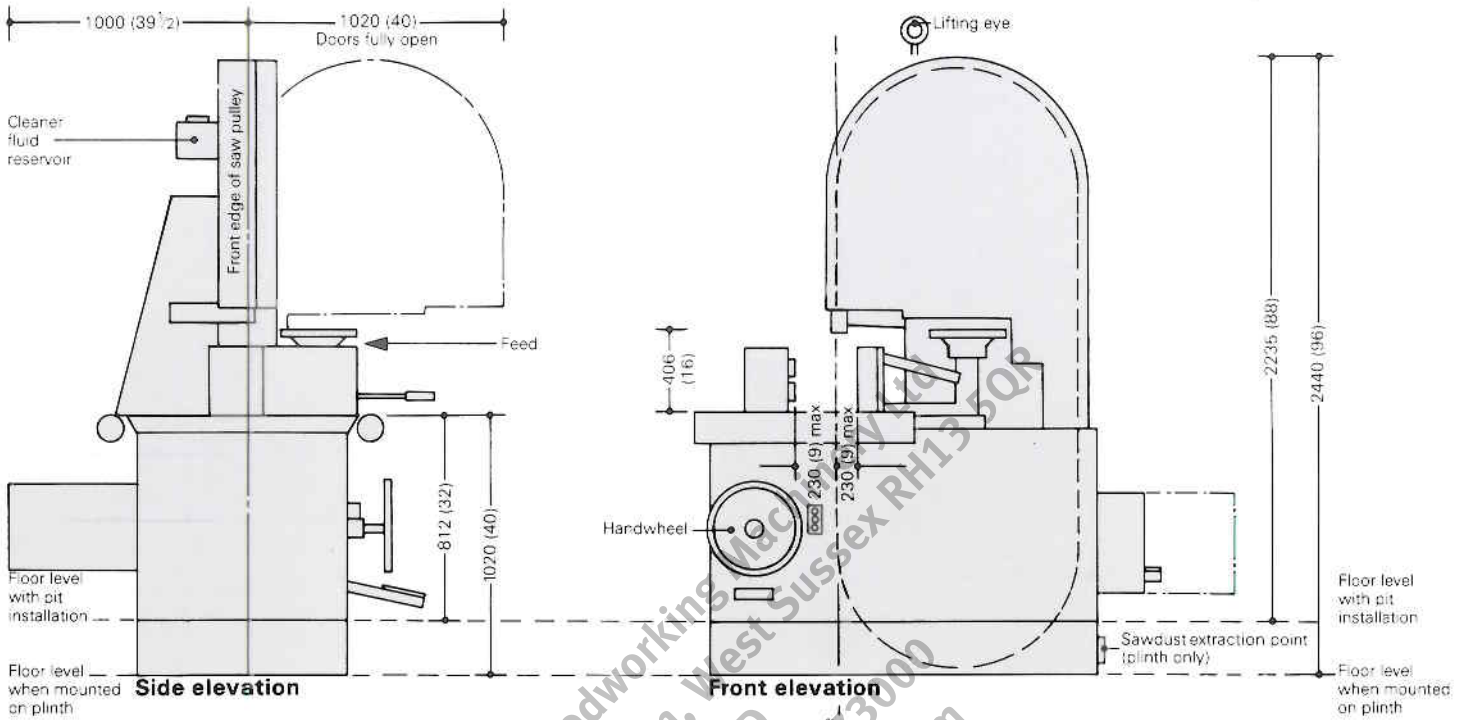
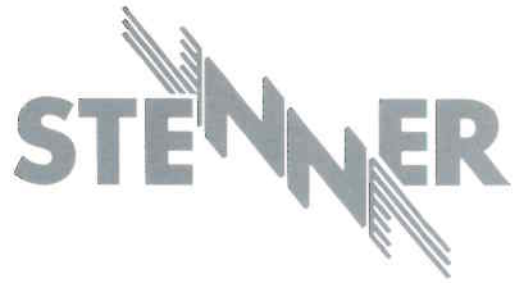

Vhm36 Specification

Length: 1815mm (6' 0")
 Width: 1685mm (5' 7")
 Overall height from floor level (with pit): 2235mm (7' 4")
 Overall height from floor level (with plinth): 2440mm (8' 0")
 Table height from floor level (with pit): 812mm (2' 8")
 Table height from floor level (with plinth): 1020mm (3' 4")
 Weight: 1890kg (4170lb)
 Main motor: 15kW (20HP)
 Feed motor: 0.75kW (1HP)
 Capacity:
 Maximum opening fence to saw line: 230mm (9")
 Maximum opening feed rolls to saw line: 230mm (9")
 Depth of cut: 406mm (16")
 Feed speeds, m/min (ft/min): 9(30), 19(63), 28(93), 37(123).
 Pulley diameter: 914mm (36")
 Pulley face width: 89mm (3 1/2")
 Blade width: 100mm (4")
 Blade length: 5.587m (18' 4") max. 5.384m (17' 8") min.

Linear saw speed: 35.5m/sec (7000 ft/min)

Sawdust extraction requirements: The extraction volume is 1455m³/hour (850ft³/min) using 150mm diameter pipe.
 Air flow: 22.86 m³/sec (4500ft³/min)

Options

Main motor: 18kW (25HP)
 Infinitely variable feed system: 0-50m/min (0-165ft/min).
 Special feed rolls.
 Timber support system.

Safety

Machine is fully guarded to BS 5304 requirements.

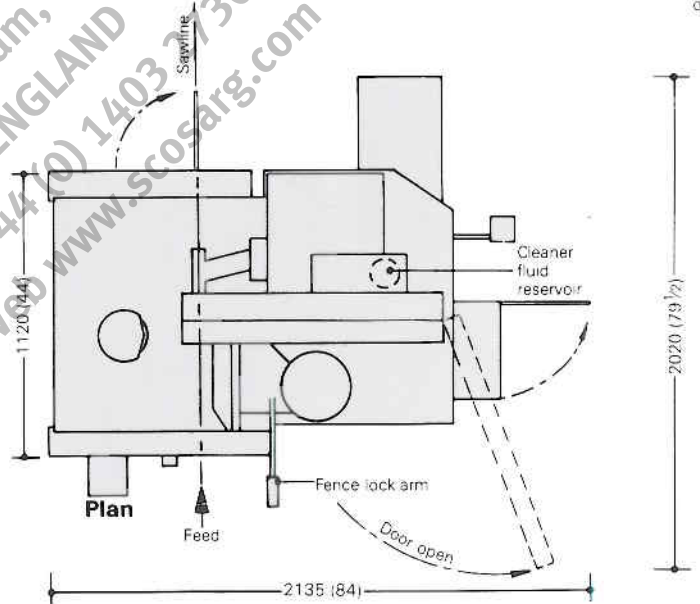

Distributor

Stenner has a company policy of continuous improvement and development, therefore specifications are subject to change without notice. The company accepts no responsibility for discrepancies in specifications or illustrations contained in its publications.

Stenner of Tiverton Limited
 Sawmilling Machinery
 Manufacturers

Tiverton Devon EX16 4JX
 United Kingdom

Telephone (0884) 253691
 Telex 94013695 STEN G
 Fax (0884) 257794